

INSTRUCTIONS FOR STD SWAB SAMPLE COLLECTION

PLEASE READ ALL INSTRUCTIONS BEFORE COLLECTING YOUR SAMPLE

YOUR MULTIPLE PURPOSE KIT CONTAINS

x1 Swab



x1 Return Bag & 1 Return Label*



* If you chose no return label option, please contact support if you changed

THIS KIT IS USED FOR THE FOLLOWING INFECTIONS

- Mycoplasma
- Ureaplasma
- Chlamydia
- HPV
- Herpes
- Gonorrhoea
- Trichomoniasis

STEP 1 BEFORE TAKING YOUR SAMPLE



LOGIN INTO YOUR ACCOUNT, CLICK ON **SAMPLE ACTIVATION AND RESULT** AND ON THE RIGHT SIDE YOU WILL SEE YOUR TEST. CLICK ON **CUSTOMER STAGE CD BOX** AND ENTER YOUR **RETURN TRACKING NUMBER** AND BELOW THE **BARCODE FROM YOUR TUBE**. PLEASE DO NOT MISS THIS STEP AS IF YOU DON'T ACTIVATE YOUR SAMPLE, WE WON'T BE ABLE TO RECOGNISE THE SAMPLE WHEN ARRIVING IN THE LABORATORY AS BEING YOURS WHICH WILL RESULT TO DISCARD YOUR SAMPLE. PLEASE NOTE THAT YOU NEED TO ENTER THE TRACKING NUMBER WITHOUT ANY SPACES AND WITHOUT THE #. **PLEASE USE ONLY THE TRACKING NUMBER FROM THE RETURN BAG.**

STEP 2 TAKING YOUR SAMPLE

Wash your hands with soap, rinse and dry them. Hold the cap, remove the swab from the plastic tube and place

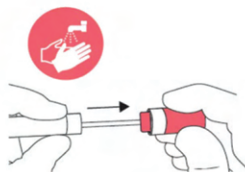

Hold the swab by your hand at the round protrusion in the middle of the rod (as shown in the figure).



Note: Do not hold the cap during the sampling process. (Red tube color is for illustration purposes only.)

STEP 3 Males go to step 4

Female: Position yourself in one of the positions shown on the below:

- A: Stand with your legs on either side of the toilet
- B: Sit on the toilet with your legs apart

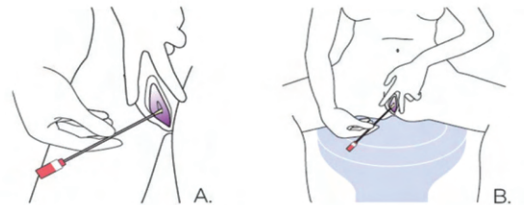

STEP 4

Female:

1. Use your other hand to spread apart the skin folds covering the vaginal opening.
2. Slowly and carefully insert the swab into the vaginal opening while your fingers touch the vulva.
3. Gently rotate at least 4 times and hold for 10 to 30 seconds. If the operation is difficult, please do not try to continue. Please ensure that the swab contacts the vaginal wall so that the secretions can be absorbed.
4. Remove the swab. Be careful not to touch your skin.

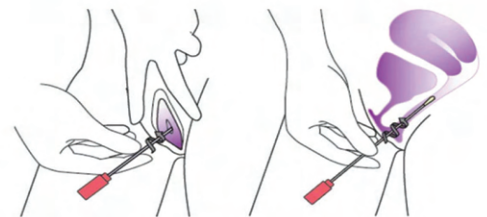

Male:

Insert the swab 2-3 cm into your urethra and turn gently for 20 seconds. Remove carefully without snapping the swab.

Do not urinate at least for 1 hour before taking the sample.

Note: Do not forcefully insert the swab. If you experience pain or unusual bleeding, consult a medical professional.



STEP 5

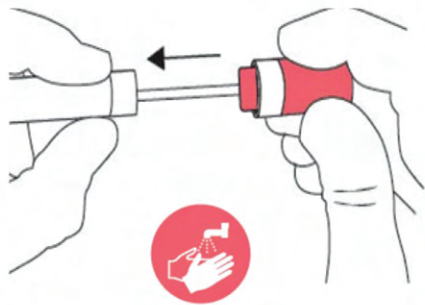

Hold the red cap, insert the swab into the plastic tube and tighten it. Wash your hands with soap,

STEP 6



Place the swab inside the provided return bag.

STEP 7

Make a note of the return tracking number found under the barcode on the postal tracking label as shown and the serial number from the sample tube found under the barcode. Fix the label to the return bag. Keep this in a safe place for future reference.



SAMPLE TUBE NUMBER **RETURN TRACKING NUMBER**

STEP 8

Once you've completed it, please drop it off at your nearest Royal Mail street box or outside any post office. Do not bring it inside the post office, as union regulations and data systems prevent post office staff from handling sample transport.



BEFORE YOU SEND YOUR SAMPLE DOUBLE CHECK THAT YOU HAVE:

Checklist

- Activated your sample.
- Collection tube securely closed.
- Kept a record of the tracking and tube number.

Intended Use Dry swab recovers viruses like Chlamydia, HPV, Mycoplasma, Gonorrhoea, Ureaplasma, Herpes, Trichomoniasis. Compatible with molecular and cell culture techniques. This product contains no hazardous constituents, or the concentrations of all chemical constituents are below the regulatory threshold limits prescribed by European directive 1272/2008/EC and the Occupational Safety Health Administration Hazard Communication Standard 29 CFR 1910/1200 and the Canadian Workplace Hazardous Materials Information System (WHMIS).

Safety Precautions Only use the equipment provided to take your sample. Kit to be used for intended use only. Keep out of reach of children.

Warnings Do not open the collection tube until time of intended use.

Contraindications Not to be used by persons under the age of 18 years old.

Storage Do not expose to direct sunlight. Store product at 5°C to 25°C. Store in cool, dry conditions.



MWE Corsham UK SN13 9RT



Advena Ltd, Swatar 4013 MALTA

KEY TO SYMBOLS



Consult instruction for use



Lot #



Use By



Keep out of sunlight



For in-vitro diagnostic use. Sample self-collection



Store at less than 25°C



Manufacturer



Sterile R



Authorized Representative



Biohazard



Do not re-use



EU Conformity Assessed



Catalog #

TIPS FOR SUPPORT

1. Try logging in at <https://medicinesbymailbox.co.uk/my-account/> or <https://medicinesonline.org.uk/my-account/>
2. It's illegal to drop samples at post offices. Please drop them at the red post boxes.
3. While you selected next day delivery with Royal Mail, Royal Mail is the only UK authorised transport company from sample returns. And we are compelled by the government to use them for that. Recent structure delays can occur within Royal Mail's network especially orders placed weekends or Fridays. You're entitled to claim directly using your tracking number. You can contact Royal Mail directly to file a complaint at +44 345 774 0740.
4. STD samples are fine for 7-14 days depending on a number of factors. Most actually will be okay for up to 30 days. Blood sample tubes have an additive which keeps blood up to 7-14 days in most cases it's fine.
5. We are required to reject improper samples.
6. These instructions are for use with the following websites:
 - www.medicinesonline.org.uk
 - www.medicinesbymailbox.co.uk
 - www.pooos.com

CUSTOMER SERVICE
WHATSAPP: 44 (0) 7737 331 342

VERSION 6.1